



ALLIANCE RV

AFTERMARKET PARTS CATALOG

PARTS@ALLIANCERV.COM

MEET THE PARTS TEAM



(Pictured left to right): Brandy, Nayeli, Abbi, Heaven, Kaylee, Brenda, Jasmine, Megan, and Veronica.

Introducing the New Alliance Aftermarket Parts Catalog! All listed parts are immediately available for purchase through our dedicated Parts Department. If you are unable to locate the item you need, please email our team; we are happy to provide personalized assistance. We are committed to growth and will be continuously expanding our catalog with new inventory; make sure to check back frequently!

We value your feedback. Send us your suggestions for parts you'd like to see added.

ORDER NOW

@ PARTS@ALLIANCERV.COM



TIRE PRESSURE MONITORING SYSTEM & CAMERA OPTIONS



PART #36789

Upgraded Color Touch Screen Display



PART #36788

Basic Color Wide Screen Display

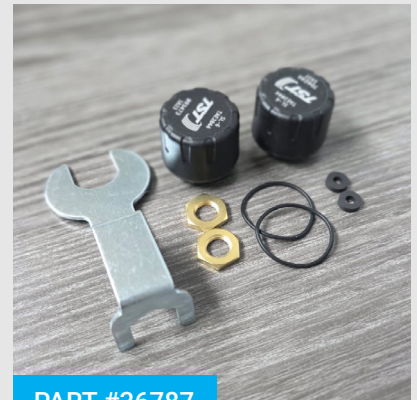

PART #36787

Cap Sensors (2 pack)
*requires 1 pack per axle

*NOT FACTORY PREPPED? NO WORRIES WE GOT YOU COVERED. EMAIL US FOR ASSISTANCE



PART #37528

Flow Thru Sensors (2 pack)

*for metal valve stems only

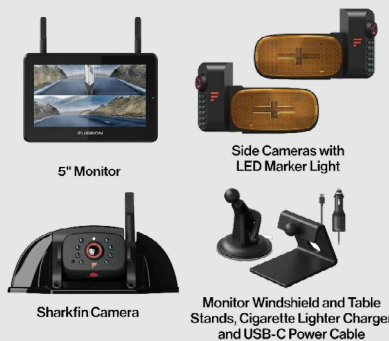

PART #37461

Furrion Vision S® + Camera Kit

*includes 5" Monitor, Marker Light Cameras, Rear Sharkfin Camera and Mounting Hardware



PART #37462

Furrion Vision S® + Camera Kit

*includes 7" Monitor, Marker Light Cameras, Rear Marker Light Camera, Rear Sharkfin Camera and Mounting Hardware

ORDER NOW

@ PARTS@ALLIANCERV.COM

BIKE RACKS & MISCELLANEOUS PARTS

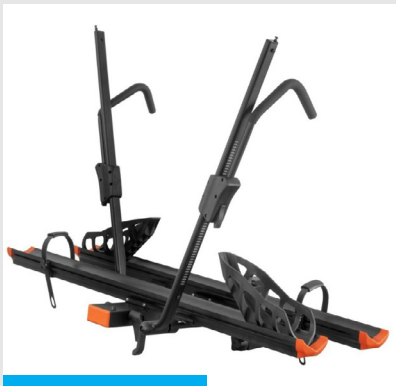

PART #37463

CURT® Aluminum 2-Bike Tray-Style Receiver Hitch Rack w/ Lock



PART #37545

CURT® Steel 2-Bike Tray-Style Receiver Hitch Rack w/ Lock



PART #37469

Locking Fuel Cap for Valors
(Replaces ECI Standard Cap)

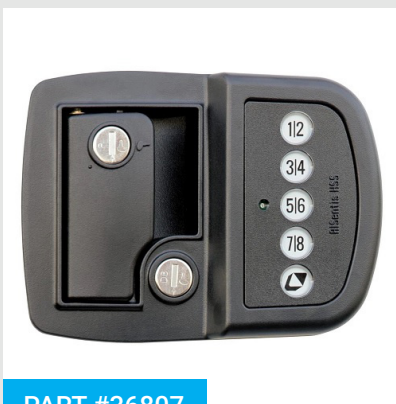

PART #36807

Bluetooth Keyless Entry System
(Right-Hand Doors)

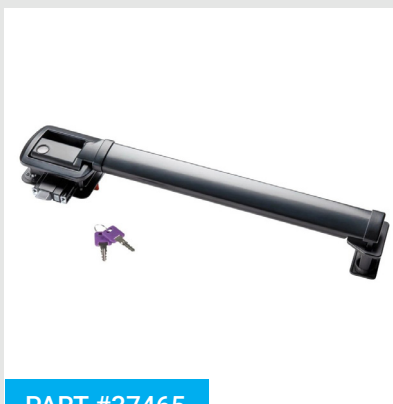

PART #37465

Right-Hand Entry Latch Extension Kit



PART #35911

Thin Shade for Entry Door

Fits cutouts: 2.75" x3.75"
Door thickness: 1.375" to 1.50"

ORDER NOW

@ PARTS@ALLIANCERV.COM

RV STEP COVERS & SOLERA AWNING ACCESSORIES



PART #37470

MORryde® 4 Step Tread Cover
*for 23.5" treads



PART #37471

MORryde® 3 Step Tread Cover
*for 19.5" treads



PART #37472

MORryde® 4 Step Tread Cover
*for 19.5" treads

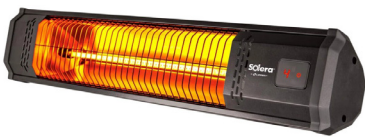

PART #37464

Solera® Awning Heater



PART #37465

Awnbrella
*supports 2 pack for awnings 10-14'



PART #37466

Awnbrella
*supports 3 pack for awnings over 14'

ORDER NOW

@ PARTS@ALLIANCERV.COM

BLU TECH WATER FILTER & SINK COVERS



PART #33818

BLU Tech 10" Water Filter



PART #37201

**Water Filter Cartridge
Replacement**

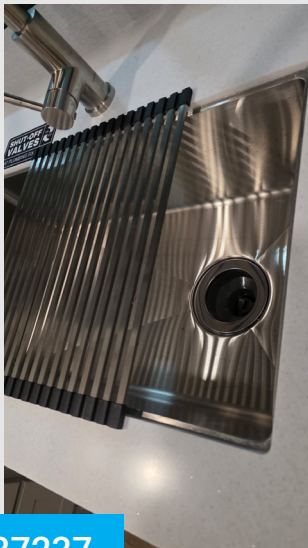

PART #37237

**Roll-Up Sink Cover for Delta &
Avenue Sinks**

Dimensions: 11.625" x 14.625"

Note: This cover rests over the sink opening and does not fit
inside the sink lip.



PART #11108

**Roll-Up Sink Cover for Paradigm,
Valor, & Benchmark Sinks**

Dimensions: 25.5" x 14.75"

ORDER NOW

@ PARTS@ALLIANCERV.COM

MORRYDE SWIVEL AND PASS-THROUGH BRACKETS & FOLDING TABLE

MORryde® Swivel Table Bracket

PART #29200

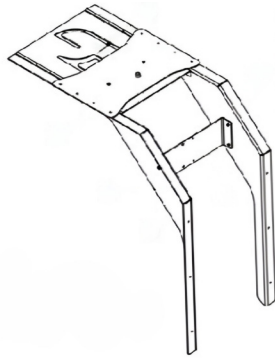

Maximize your space: This swivel bracket easily rotates your dinette table into an accessible desk.

1.8 % Incline.

Please verify your unit includes the necessary backing structure for installation. Absence of backing may require structural modifications.

Pass-Through Table Bracket

PART #24115

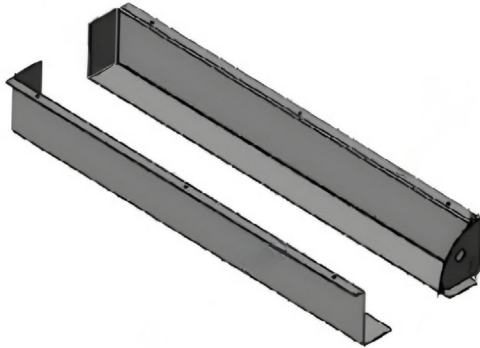

Effortlessly store your additional outdoor table. Brackets are secured to the upper surface of your storage compartment.

Single table storage.

6' Fold-In-Half Banquet Table

PART #24085



Durable, easy to clean, and built for heavy-duty use. Folds neatly to save space and features a carrying handle for maximum portability.

ORDER NOW

@ PARTS@ALLIANCERV.COM

ENTRY DOOR PROTECTION



Screen Shot - Screen Door Closer

PART #37492

26" Entry Door

PART #37493

28" Entry Door

PART #37494

30" Entry Door

Screen Defender

PART #37495

26" Entry Door

PART #37496

28" Entry Door

PART #16538

30" Entry Door



Push Bar - Screen Assist

PART #37497

26"-30" Entry Door

ORDER NOW

@ PARTS@ALLIANCERV.COM

MORRYDE® CARGO TRAYS



FEATURE	DETAILS
Extension Options	Choose between 60% extension (36" to 90" length) or 80% extension (72" fixed length).
Width Range	Available in widths ranging from 20" to 52".
Accessibility (80% Trays)	80% extension trays pull through both sides of the storage compartment for complete access.
Slide Mechanism	Features a smooth ball-bearing slide mechanism.
Weight Capacity	60% Extension: 800 lb. capacity. 80% Extension: 500 lb. capacity.
Flooring	Durable carpeted flooring.
Installation	Includes a generic hardware kit.
Assembly	Unit comes fully assembled.

Pricing and availability are determined on a case-by-case basis due to numerous size and extension options. To get a quote, please measure the width, length, and the compartment lip height.

ORDER NOW

@ PARTS@ALLIANCERV.COM

EXTERIOR DECALS



PART NUMBER	COLOR	SIZE
a. 16129	Chrome	15.8" x 8.9"
b. 25260	Black Metallic	14.2" x 8.2"
c. 34162	White (Letters Only)	2.16" x 32.81"
d. 33614	Slate Gray	21.7" x 10.2"
e. 33617	Black Stripe w/ Gray Letters	98" x 6.3"
f. 34424	Dark Smoke	19.5" x 11.6"
g. 29340	Alloy Metallic	33.2" x 2.1"

ORDER NOW

@ PARTS@ALLIANCEV.COM

BUILT INDEPENDENT

From luxury fifth wheels to ultra-light travel trailers and spacious destination models, our lineup is designed to match your lifestyle

At Alliance RV, our vision is to create a product driven by our customers, through their experience and input, and execute on those ideas at the highest level. Innovation and product development is best done in collaboration with the RVing community, and we are listening. Many of us here at Alliance RV have spent the majority of our careers in the RV industry, and we believe our RV owners and dealer partners will welcome an independent and truly different manufacturer that is transparent and dedicated to their customers.



DELTA

AVENUE

BENCHMARK

-VALOR-

PARADIGM

ALLIANCE

@ PARTS@ALLIANCERV.COM

