

TECH TIP: DISASSEMBLING/CLEANING THE KITCHEN FAUCET SPRAYER

1



Remove the **sprayer switch** with a flathead screwdriver.

2



Remove the screw on **retaining ring** counterclockwise (Use a flathead screwdriver to get it started)

3

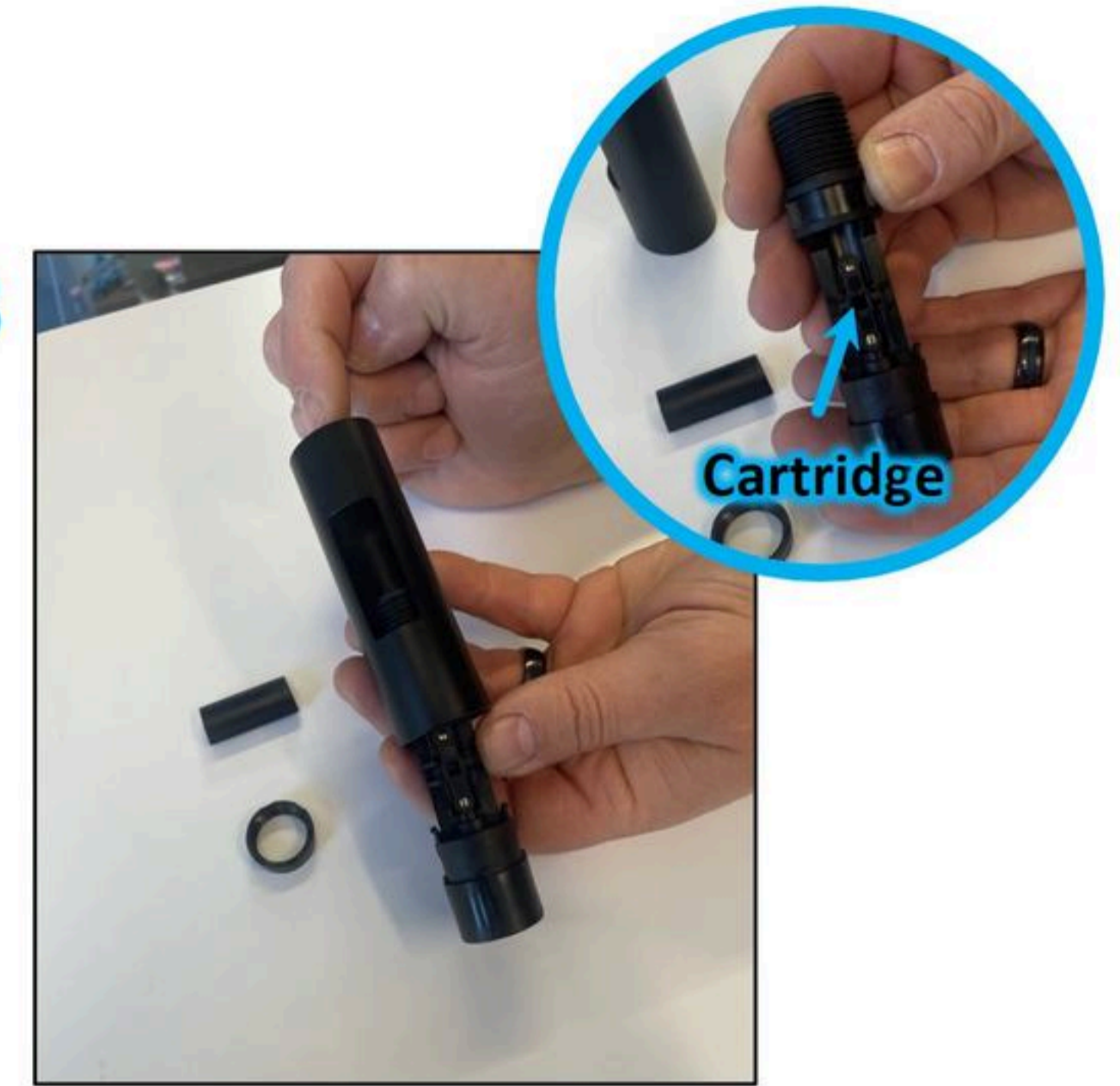

Push the **cartridge** assembly out of the sprayer housing.

4



Unclip and remove the **sprayer nozzle** with a flathead screwdriver.

5

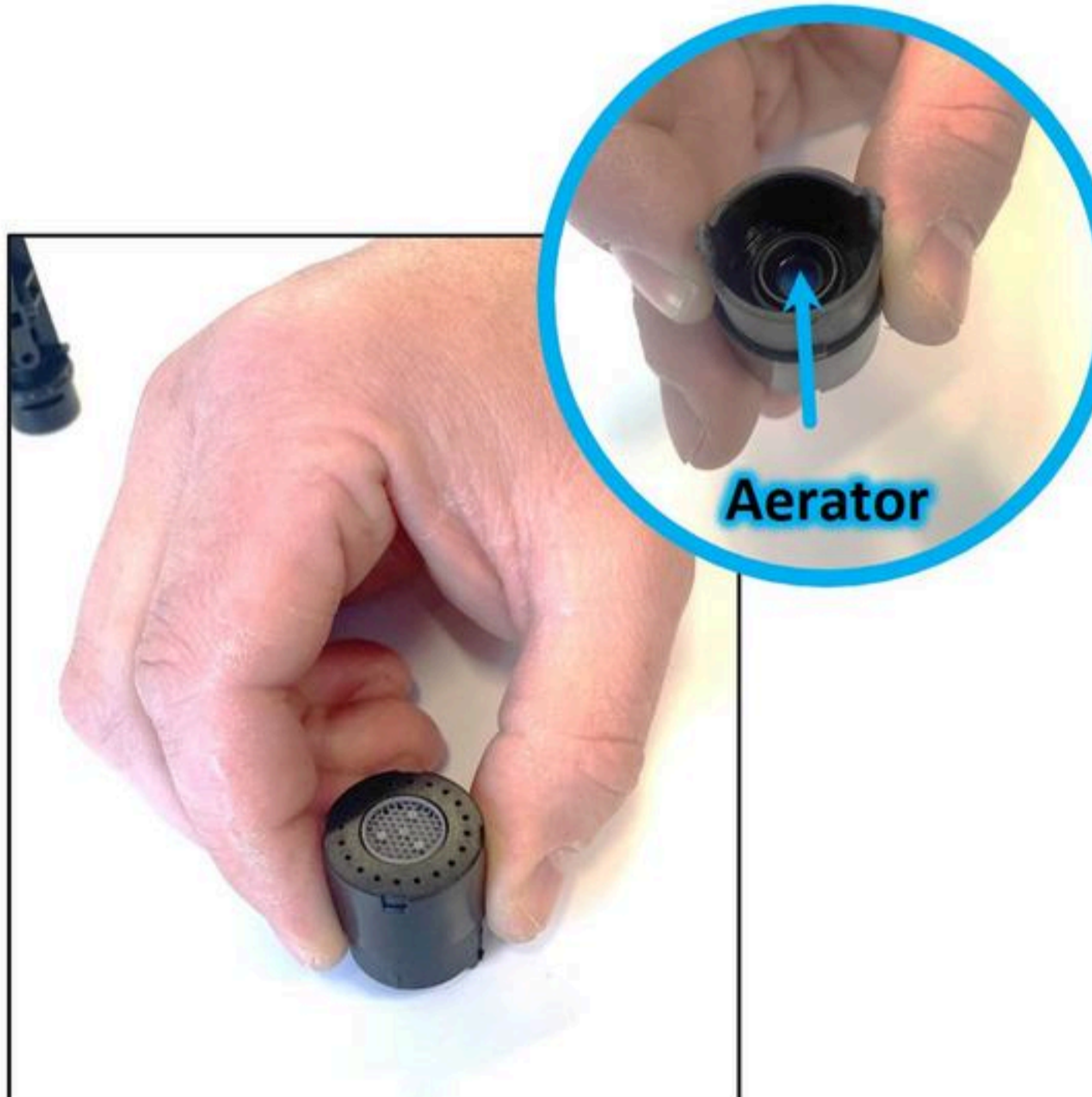

With the sprayer nozzle removed you will be able to access the **aerator** and remove any buildup or debris.

If you are experiencing lower than expected waterflow at the kitchen sink, the following instructions walk you through how to disassemble the sprayer head to remove and buildup or debris that could be causing this blockage.